

公司总部及各办事处联系方式

中国华南制造基地	South China Manufacture Basis
广东拓斯达科技股份有限公司	GUANGDONG TOPSTAR TECHNOLOGY CO.,LTD
地址: 广东省东莞市大岭山镇大塘朗创新路2号	ADD: No.2 Chuangxin Road, Datanglang, Dalingshan Town, Dongguan City, Guangdong Province.
电话: 0769-8305 0999	TEL: 0769-8305 0999
传真: 0769-8584 5562	FAX: 0769-8584 5562
邮箱: marketing@topstartd.com	E-mail:marketing@topstartd.com

江苏拓斯达机器人有限公司	Jiangsu Topstar Robot Co.,Ltd
地址: 江苏省苏州市吴中经济开发区郭巷街道吴淞路818号1幢3楼	ADD: 3rd Floor, Building 1, No. 818, Wusong Road, Guoxiang Street, Wuzhong Economic Development Zone, Suzhou City, Jiangsu Province, China
电话: 0512-8686 4305 手机: 139 1543 5939	TEL: 0512-8686 4305 MOB: 139 1543 5939

昆山拓斯达机器人科技有限公司	Kunshan Topstar Robot Technology Co.,Ltd
地址: 江苏省昆山市新南路888号联邦国际商务花园18栋	ADD:Building 18, Federal International Business Garden, No. 888 Xinnan Road, Kunshan City, Jiangsu Province, China
电话: 0512-3688 1796	TEL: 0512-3688 1796
手机: 185 0156 0757	MOB: 185 0156 0757

宁波拓晨机器人科技有限公司	Ningbo Topstar Robot Technology Co.,Ltd
地址: 浙江省宁波市北仑区大碶街道大塔路8号	ADD: No.8 Great Tower Road,Daqi Street,Beilun Area,Ningbo City, Zhejiang Province, China
电话: 0574-8610 5571	TEL:0574- 8610 5571
传真: 0574-8610 5571	FAX:0574- 8610 5571
手机: 137 7723 2779	MOB:137 7723 2779

华中服务办事处

地址: 湖北省武汉市经济开发区创业路嘉昱公馆302-305室
电话: 186 6539 0687

Central China Service Offices,China

ADD:Room 302-305, Jiayu Mansion, Chuangye Road, Economic Development Zone, Wuhan City, Hubei Province, China
TEL: 186 6539 0687

华北服务办事处

地址: 天津市西青区海泰产业园区西南侧香海花园10-3
电话: 022-8798 5589
手机: 139 2586 4489

North China Service Offices,China

ADD:10-3 Xianghai Garden, Southwest Side, Haitai Industrial Park, Xiqing District, Tianjin,China
TEL:022-8798 5589
MOB:139 2586 4489

越南服务办事处

地址: 北江市黎利坊雄王路3号TUTACENTER一楼
手机: 186 0209 6307 / 0084-346 860 156

SVietnam Service Office

Address: 1st Floor, TUTACENTER, No. 3, Xiongwang Road, Lilifang, Bac Giang
MOB: 186 0209 6307 / 0084-346 860 156

有关产品性质和适用范围的说明并不保证产品属性, 仅作可供了解的信息。我们的供货范围及提供的服务完全以合同条款为准绳。技术数据和插图仅作为供货参考。保留更改权利。

Feature and scope of the product does not guarantee the product attributes,only for reference.Our scope of delivery and services provided are based solely on the terms of delivery and services provided,are based solely on the terms of the contract.Technical data and illustration are only for reference .We reserve the rights of changing



全国统一客服热线

Domestic Service Hotline
400-096-8006

http://www.topstartd.com

版本号: TSDSC2021-C

TM系列注塑机

TM SERIES INJECTION MOLDING MACHINE

机械的种类: 机铰式液压伺服驱动

Type:Toggle hydraulic servo driven

股票代码 Stock Code
300607



CONTENTS

目录

01

公司介绍

About Us

公司简介	03-04
Company profile	
企业文化	05-05
Company Culture	
资质评定	06-06
Qualification evaluation	
发展历程	07-08
Development History	

02

产品介绍

Product Introduction

产品介绍	12-12
Product Introduction	
应用行业	12-12
Application industries	
产品配件	13-13
Product accessories	
产品特点	14-14
Product Features	
产品参数	15-17
Product Parameters	
产品规格	18-18
Product Specification	
产品安装尺寸	19-19
Installation dimensions	
标准系列配置表	20-22
Standard series configuration table	

03

客户服务

Chapter of Service

售后服务	25-25
After-Sale Service	
全球服务网点	26-26
Global Service Net	

01

About Us
公司介绍

公司简介、企业文化、资质评定、发展历程
Company profile、history、qualification、corporate culture



Company profile

公司简介

广东拓斯达科技股份有限公司（简称：拓斯达，股票代码：300607）是首家登陆创业板的广东省机器人骨干企业。公司成立于2007年，总部位于广东省东莞市大岭山镇，注册资本4.26亿元。

拓斯达坚持“让工业制造更美好”的企业使命，通过以工业机器人、CNC、注塑机为核心的智能装备，以及控制、伺服、视觉三大核心技术，打造以核心技术驱动的智能硬件平台，为制造企业提供智能工厂整体解决方案。截至2021年6月，公司已在全国设有近50家办事处，触达客户超20万家，服务客户超15000家。

拓斯达是国家高新技术企业，建有广东省3C智能机器人与柔性制造企业重点实验室、广东省工业机器人与智能装备驱动一体化系统及应用技术工程技术研究中心、广东省企业技术中心、广东省博士工作站。公司2018年荣获“东莞市政府质量奖”，2019年纳税首次破亿，并荣获“2019年度东莞市效益贡献奖”，“2019年度东莞市规模效益成长性排名前20名工业企业”，2020年荣获“东莞市先进集体”等荣誉。

截至2021年6月，拓斯达拥有授权专利464项，其中发明专利26项；各类软件著作权69项。公司多项产品荣获广东名牌产品、广东高新技术产品，并通过欧洲CE认证。

Guangdong Topstar Technology Co., Ltd. (abbr. Topstar, stock code: 300607) is the first GEM listed core robot enterprise in Guangdong Province. The company was founded in 2007 and is headquartered in Dalingshan Town, Dongguan City, Guangdong Province, with a registered capital of 426 million yuan.

Topstar adheres to the corporate mission of "making industrial manufacturing better", through intelligent equipment with industrial robots, CNC and injection molding machines as the core, as well as controllers, servo drives, and vision system as three core technologies create an intelligent hardware platform driven by core technologies, and provide manufacturing enterprises with turnkey solutions for smart factories. As of June 2021, the company has set up close to 50 offices across the country, reaching more than 200,000 customers and serving more than 15,000 customers.



15000+
服务企业客户



自主研发
能力强



社会
认可度高



坚持
“让工业制造更美好”

Topstar is a national high-tech enterprise. It has established the Guangdong Key Laboratory of 3C Intelligent Robots and Flexible Manufacturing Enterprises, Guangdong Engineering Technology Research Center for Industrial Robots and Intelligent Equipment Driving and Control Integrated System and Application Technology, Guangdong Enterprise Technology Center, Doctoral Workstation of Guangdong Province. In 2018, Topstar won the "Dongguan Municipal Government Quality Award". In 2019, the tax payment exceeded 100 million for the first time, and awarded "2019 Dongguan City Benefit Contribution Award" and "2019 Dongguan City Scale Efficiency Growth Ranking Top 20 Industrial Enterprises". In 2020, Topstar won the "Dongguan Advanced Collective" and other honors.

As of June 2021, the company has 464 authorized patents, including 26 invention patents; 69 software copyrights. Many of the company's products have been awarded Guangdong Famous Brand Products, Guangdong High-tech Products, and have passed CE certificate.

Company Culture

企业文化

企业使命

Enterprise Mission

让工业制造更美好!
Make Industrial Manufacturing Better!

企业定位

Enterprise Positioning

专注建立工业机器人、自动化解决方案生态圈的全球智能制造综合服务平台。

Global intelligent manufacturing service platform, focus on industrial robots and automation solutions.

企业愿景

Enterprise Vision

助力100万制造企业实现智能制造;助力100万工程师服务于智能制造。
To help millions of manufacturing enterprises to realize intelligent manufacture;
To help millions of engineers serving the intelligent manufacture.

核心价值观

Core Values

全心全意为客户服务!
群体奋斗群体成功!
Wholeheartedly for Customer Service!
Together We Strive, Together We Achieve!

组织气质

Team Spirit

开放协同, 因我不同。
Cooperate but respect personality

拓斯达不是雇佣和解雇型企业, 而是打造创业型平台, 集众人之力, 实现凭一己之力所无法达成目的的平台, 其核心精神是“分享”。——《拓斯达宣言》
TOPSTAR is not a hiring or dismissal enterprise, but aim to create a business platform, which setting the power of everyone to achieve the goal which can not be achieved by their own. Its core spirit is "share".



Qualification evaluation

资质评定

拓斯达坚持技术为王的经营理念, 先后取得了各项高新技术企业的资质和认证, 为客户提供先进和高端的产品。

Topstar adheres to the business philosophy, which puts technology in the dominant position. It has successively obtained many qualifications and certifications of high-tech enterprises, and provided the most advanced and high-end product to customers.

国家级高新技术企业认证、欧盟CE认证、ISO9001质量体系认证、广东省名牌机器人、广东省“守合同重信用”企业、粤港澳大湾区联合创新中心创新基地、累计产品技术专利258项、广东省级企业技术中心、华南理工大学产学研合作基地、校企合作实践基地...

National high-tech enterprise certification, CE Certification, ISO9001 Quality System Certification, Guangdong Province Top Brand Robot, Guangdong Province "contracts observing and credit honoring" enterprises, Guangdong-Hong Kong-Macao Greater Bay Area Joint Innovation Center, 258 technology patents for products, Guangdong province enterprise technology center, South China University of technology production and research cooperation base, School-enterprise cooperation practice base...



Development History

发展历程

2008

创新研发辅机，开拓市场

研发出新型节能三机一体机；
研发出直接冷却160度水温机，降温速度更快。

2008

Innovative R&D auxiliary machines to expand the market

Developed a new energy-saving 3 in 1 heatless dehumidifier;
Developed a direct cooling 160 degree water temperature machine, and the cooling rate is faster.

2009

提高产品自产，客户达1000家

成立拓斯达商学院；
市场成交客户量突破一千家；
成立钣金厂，提高自产率，产能再次提升。

2009

Improve product self-production, customers up to 1000

Established the Topstar Business School;
The number of customers in the market exceeded one thousand;
The establishment of a sheet metal factory to increase self-yield and increase production capacity.

2010

开发机械手，布局全国市场

开发机械手产品，成为自动化系统输出全套产业链运营商；
无锡分公司成立，辐射华东，开启全国市场布局；
与清华大学合作，引入先进的企业管理理念。

2010

Development linear robot, layout of the national market

Develop robot products and become a complete industrial chain operator for automation system output;
The establishment of Wuxi Branch, radiating East China, opened the national market layout;
Collaborate with Tsinghua University to introduce advanced corporate management concepts.

2007

50万注册成立拓斯达

拓斯达以50万元注册资金注册成立；
提出“打造一流品质”的企业和产品定位；
制定出行业内部标准，重新定义行业高端产品标准。

2007

500,000 yuan registered to establish Topstar

Topstar was registered with a capital of 500,000 yuan;
Put forward the enterprise and product positioning of "building world-class quality";
Develop the industry's first internal standard and redefine industry high-end product standards.

2011

注塑自动化全套解决方案运营商

自主研发的三轴、五轴伺服机械手下线，获得客户广泛好评；
确立整体注塑自动化解决方案，提出主动服务理念；
成功举办“华南塑料工业高端论坛”。

2011

Injection Automation Complete Solution Operator

The self-developed three-axis and five-axis servo manipulators went offline and received wide acclaim from customers;
Establish an overall injection molding automation solution and propose an active service concept;
Successfully held the "High-end Forum on Plastics Industry in South China".

2012

认证高新企业，布局全球市场

获得国家高新技术企业称号；
布局全球市场，产品销往东南亚、欧洲、南美洲等地市场；
与华南理工大学签署产学研合作协议。

2012

Certified high-tech companies, global market layout

Obtained the title of national high-tech enterprise.
Layout of the global market, the products are sold to markets in Southeast Asia, Europe, South America, etc.;
Signed an industry-university-research cooperation agreement with South China University of Technology.

2013

引入战略投资，多领域自动化

投资6亿扩产自动化制造基地，项目纳入东莞市重点建设项目；
组建自动化项目部，布局打磨、冲压、压铸等多领域自动化进行股份制改革，核心员工持股。

2013

Introducing strategic investment, multi-domain automation

Invested 600 million expansion production automation manufacturing base, the project was included in the key construction projects in Dongguan;
Set up an automation project department, layout polishing, stamping, die casting and other multi-field automation;
The shareholding system reform was carried out and the core employees held shares.

2014

挂牌新三板，响应机器人换人

挂牌新三板，实现同步定增；
率先响应机器人换人政策，提出一年回本的自动化理念；
华北、华中营销中心成立，全国新设20余办事处，推动自动化改革。

2014

Listed New OTC(Over the Counter) Market, responsive machine alternative manual strategy

The new three boards will be listed for synchronous growth;
Take the lead in responding to the machine alternative manual strategy and propose a one-year automation concept;
The North China and Central China Marketing Centers were established, and more than 20 new offices were set up across the country to promote automation reform.

2015

掌握核心技术，研发工业机器人

掌握控制系统核心技术，布局工业机器人研发；
形成多领域工业机器人自动化、整厂水电气系统、配套设备智能体系。

2015

Mastering core technologies and developing industrial robots

Master the core technology of the control system and lay out the development of industrial robots;
Forming multi-domain industrial robot automation, whole plant water and electricity systems, and supporting equipment intelligent systems.

2017

Landing on the GEM, expand employee holdings

GEM listed, stock code 300607. Expanded employee holdings of more than 200;
We will build an intelligent manufacturing integrated service system with industrial robots as the core and combining software and hardware. We will output intelligent manufacturing overall solutions through four departments and two organizations;
Import SAP information management and qualification system to improve management team effectiveness.

2018

入驻新园区，赋予新使命

发布新使命、愿景、价值观，确定新组织气质；
迁入全新的大塘朗园区，首次举办全球开放日；
优化产业布局，收购野田智能、筹建江苏拓斯达、置地松山湖与沙田。

2018

Entering the new park, giving new mission

Publish new missions, visions, values, and determine new organizational temperament;
Moved to the new Datanglang Park for the first time to hold the Global Open Day;
Acquired Noda Intelligence, prepared Jiangsu Topstar, Landsong Songshan Lake and Shatian to optimize industrial layout.

2019

拿结果 强组织 做价值

1. 苏州生产研发基地正式开工；
2. 成立骆驼科技，布局产业互联网；
3. 公开增发募集资金总额6.5亿元；
4. 拓星辰系列上市，拓星河1号已进入Beta阶段；
5. 加强人才队伍建设引入博士3人，硕士研究生24人。

2019

Result-oriented, Organization strengthening, Value creation

1. Construction of Suzhou production, R & D base officially started;
2. Established TuoTuo Technology, laying out the industrial Internet;
3. Publicly raised funds of 650 million Yuan;
4. T-star series robots are ready to the market, T-galaxy has entered Beta phase;
5. Strengthen the talent team building, introduced 3 doctors and 24 masters.

2020

新战略 新赛道

1. 提出渠道与产品双轮驱动的智能制造综合服务平台；
2. 通过收购，全新注塑机产品面市；
3. 董事长吴丰礼参加习近平主持召开的企业家座谈会；
4. 拟发行可转债募资6.7亿元用于建设智能制造整体解决方案研发及产业化项目；
5. 服务客户数突破10000家。

2020

New strategy and new track

1. Propose an intelligent manufacturing integrated service platform with dual wheel drive for channels and products;
2. Through the acquisition, new injection molding machine products on the market;
3. Participate in the entrepreneurs' forum hosted by Xi Jinping;
4. Issue convertible bonds to raise RMB 670 million yuan for the construction of the research & development of intelligent manufacturing one-stop solution and industrialization projects;
5. Serve for over 10000 customers.

2021

强战略 平台化

1. 提出“以核心技术驱动的智能硬件平台”战略定位；
2. 自动化设备综合服务平台“集成侠”上线；
3. 可转债再融资6.7亿。

2021

Intensify strategy and platformization

1. Proposed the strategic positioning of "Intelligent Hardware Platform Driven by Core Technology";
2. "Integration Expert", an integrated service platform for automation equipment, goes online;
3. Convertible bonds refinancing 670 million.



TM系列产品介绍
Introduction of TM series products

产品介绍、应用行业、产品配件、
产品特点、产品参数、产品规格、产品安装尺寸、标准系列配置表

Product Introduction、Application industries、Product accessories、
Product Features、Product Parameters、Product Specification、installation dimensions、
Standard series configuration table

TM series products

TM系列产品



Product Introduction

产品介绍

注塑机具有能一次成型外型复杂、尺寸精确或带有金属嵌件的质地致密的塑料制品的能力。
The injection molding machine has the ability to mold dense plastic products with complex appearance, precise dimensions or metal inserts in one go.

产品特点

Product Features



Application industries

应用行业

电子类

electronics



容器类

containers



3C家电

3C home appliances



化妆品

cosmetics



汽配行业

auto parts



快消类

FMCG



Product Accessories

产品配件

TM通用型精密伺服注塑机 90T-470T

TM general-purpose precision servo-driven injection molding machine 90T-470T



先进的油路设计，搭配欧洲专业控制器，使得机器动作稳定、制品良率高、响应速度快、控制精准、操作简单，满足多种工艺需求。
Advanced oil circuit design with European professional controller makes the machine action stable, combined with high product yield, fast response time, precise control, easy operation, and meet a variety of process requirements.



采用斜排双射油缸及线性导轨，射胶更加精准稳定。
Diagonal double injection mold shift oil cylinder and linear guide, more accurate and stable injection.

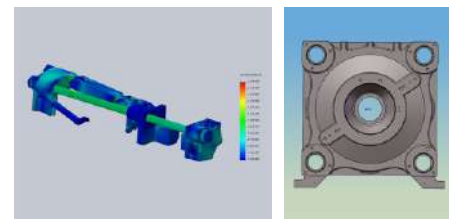

模板优化升级，结构可靠，变形小，能有效保护设备，提高模具使用寿命。
Optimized and upgraded platen, with reliable structure and small deformation, can effectively protect the equipment and improve the service life of mold.



注重客户实际体验，包括工业设计、人机交互等细节优化。
Focus on the actual customer experience, including industrial design, human-machine interaction and other details optimization.



标准螺杆：高性能氮化钢，耐用高效，应用广。
High color mixing/high mixing screw: to meet the high color mixing products, easy to change color custom screw: specially customized plasticizing components for different products, such as PC, PA, etc.

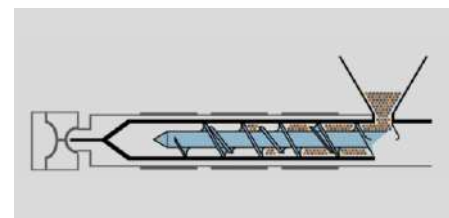

专业的塑化组件搭配，满足不同材料的塑化要求及混色性能。
Professional matching of plasticizing components to meet the plasticizing requirements and color mixing performance of different materials.

Product Features

产品特点



先进的射胶、锁模、油压系统设计，机器参数全面升级；
Advanced design of injection, mold clamping and oil pressure system, and comprehensive

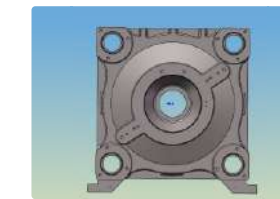

优化的超强模板，受力均衡，适用绝大多数产品；
Optimized super strong platen with balanced force, applicable to most products;

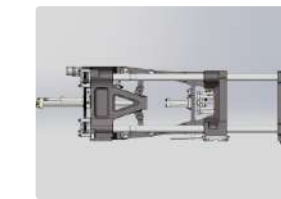

全新斜排机铰布局，可实现超长行程开模，开模位置精度<1mm，模板运动快且稳；
Brand new diagonal hinge layout, which can realize ultra-long stroke mold opening, mold opening position accuracy <1mm, fast and stable platen movement;

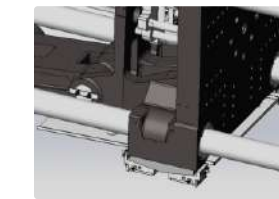

采用独特的双滑脚设计，模板平行度调节方便；
Unique double slider design, easy to adjust the parallelism of the platen;



采用欧标顶针，顶针操作空间大；
European standard ejector pin, with large operation space;

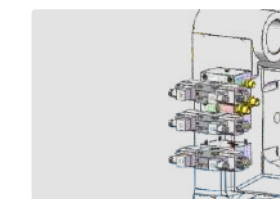

模块化抽芯油阀设计，自由搭配抽芯组数；
Modular loose core oil valve design, free to match the number of loose cores;



全新的调模机构，一键即可实现自动精准调模；
New mold adjustment mechanism, with one-key function available to realize automatic and accurate mold adjustment;

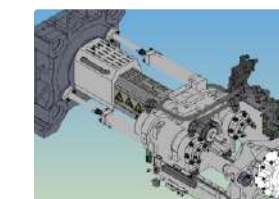

双射移搭配线性导轨，射台运动阻力小，动作灵敏，射胶精准稳定；
Double injection shift with linear guide, low resistance of injection unit movement, sensitive action, accurate and stable injection;

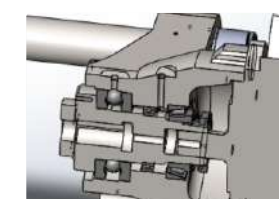

射胶传动轴采用三轴承设计，保证同轴度，螺杆料筒磨损小；
Three bearing design for the injection drive shaft to ensure coaxiality and small wear of the screw barrel;

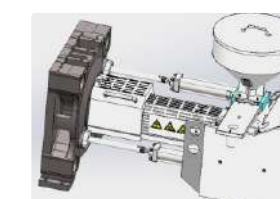

全新射台，整体框架式底座，护罩设计美观，安全稳定；
New injection unit, overall frame type base, beautiful design of shield, safe and stable;

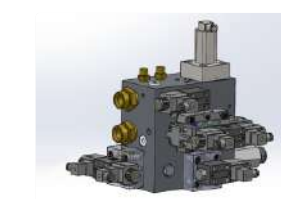

油路系统全面升级，安全，稳定，功能全，差动锁模运行周期快；
Oil circuit system fully upgraded, safe, stable, full-featured, with fast operation cycle of differential clamping;

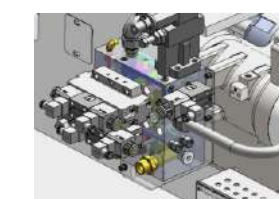

熔胶背压采用数控比例背压，控制精准；
CNC proportional back pressure of melting, precise control;



锁模油缸缓冲系统，高速高压条件下对机铰无撞击；
Clamping cylinder buffer system, no impact on the machine hinge under high speed and high pressure conditions;



采用高端进口注塑机专业电脑控制器。
High-end injection molding machine professional computer controller.

Product Parameters

产品参数

注射部份	INJECTION UNIT	UNITS	TM90			TM130			TM170			TM220			TM260			TM330			TM400			TM470		
螺杆直径	Screw Diameter	mm	32	36	40	36	40	45	40	45	50	45	50	55	50	55	60	60	65	70	65	75	75	80	85	
螺杆长径比	Screw L/D Ratio	L/D	22.5	20.0	18.0	22.2	20.0	17.8	22.5	20.0	18.0	22.2	20.0	18.2	22.0	20.0	18.3	21.7	20.0	18.6	21.5	20.0	18.7	21.3	20.0	18.8
螺杆行程	Screw Stroke	mm	150	150	150	170	170	170	200	200	200	210	210	210	240	240	240	280	280	280	320	320	320	360	360	360
注射容积	Shot Volume	cm ³	121	153	188	173	214	270	251	318	393	334	412	499	471	570	679	792	929	1078	1062	1232	1414	1590	1810	2043
注射重量(PS)	Shot Weight(ps)	g	110	139	172	157	194	246	229	289	357	304	375	454	429	519	618	720	846	981	966	1121	1286	1447	1647	1859
		oz	3.9	4.9	6.0	5.5	6.8	8.7	8.1	10.2	12.6	12.6	10.7	13.2	16.0	15.1	18.3	21.7	25.4	29.8	34.5	34.0	39.4	45.3	50.9	58.0
注射压力	Injection Pressure	kgf/cm ²	2393	1890	1531	2301	1864	1473	2362	1866	1511	2299	1862	1539	2257	1865	1567	2188	1864	1607	2085	1798	1566	1984	1744	1545
注射速率	Injection Rate	cm ³ /s	79	100	123	101	125	158	123	156	193	158	195	236	193	234	278	273	320	371	333	386	443	440	501	566
注射速度	Injection Rate	mm/s	98	98	98	99	99	99	98	98	98	99	99	99	98	98	98	96	96	96	100	100	100	100	100	100
螺杆转速	Screw Speed	rpm		240			220			200			175			175			170			170			170	
射咀推力	Nozzle Contact Force	t		4.2			4.2			6.2			6.2			6.2			9.1			9.1			9.1	
射咀行程	Nozzle Stroke	mm		260			260			280			340			340			450			450			450	
锁模部份	CLAMPING UNIT	UNITS	TM90			TM130			TM170			TM220			TM260			TM330			TM400			TM470		
锁模力	Clamping Force	t		90			130			170			220			260			330			400			470	
开模行程	Opening Stroke	mm		330			360			430			490			560			660			720			800	
模板尺寸(水平×垂直)	Platen size(H×V)	mm		530x530			600x600			680x680			790 x 790			840 x 840			970x970			1045x1045			1160x1160	
导柱内距(水平×垂直)	Space Between Tie Bars(H×V)	mm		360x360			410x410			470x470			530 x 530			580 x 580			680x680			730x730			820x820	
容模量(最薄-最厚)	Mould Thickness (Min)	mm		125			150			160			180			190			225			250			300	
	Mould Thickness (Max)	mm		400			460			540			560			600			700			750			870	
模板最大距离	Max. Daylight	mm		730			820			970			1050			1160			1360			1470			1670	
顶出推力	Ejector Force	t		3.4			3.4			4.2			6.7			6.7			6.7			11.0			11.0	
顶出行程	Ejector Stroke	mm		120			120			140			160			160			160			220			220	
定位法兰	Locating Ring	mm		100			100			125			125			125			125			160			160	
电力/电热	POWER/HEATING UNIT	UNITS	TM90			TM130			TM170			TM220			TM260			TM330			TM400			TM470		
系统压力	System Pressure	kgf/cm ²		175			175			175			175			175			175			175			175	
油泵电机功率	Pump Power	kw		13			13			18			22			26			36			45			52	
电热量	Heating Power	kw		7			9.7			10.2			13.6			17.3			21.3			23.4			31.6	
温度控制段数	Number of Temp Control Zones			3+1			3+1			3+1			3+1			3+1			4+1			5+1			5+1	
其它	OTHERS	UNITS	TM90			TM130			TM170			TM220			TM260			TM330			TM400			TM470		
机器尺寸(长×宽×高)	Machine Dimensions(L×W×H)	m		4.65x1.23x1.88			4.74x1.23x1.88			5.3x1.32x1.96			6.1x1.54x2.19			6.21x1.54x2.19			7.29x1.86x2.3			7.92x1.92x2.24			8.65x1.92x2.29	
油箱容积	Oil Tank Capacity	L		150			150			200			300			300			400			450			600	
机器重量	Machine Weight	t		3.3			3.7			4.5			6.7			7.5			11.1			14.8			17.5	
模板正面尺寸	Platen dimensions																									
模板侧面尺寸	Platen dimensions																									

钣金部分 Metal Plate		TM90	TM130	TM170	TM220	TM260	TM330	TM400	TM470
加宽机门 (双边100mm)	Widened door (100mm on both sides)	○	○	○	○	○	○	○	○
降低安全门高度	Reduce the height of safety door	○	○	○	○	○	○	○	○
同步带电动门	Synchronous with electric door	○	○	○	○	○	○	○	○
锁模区加装滑动上盖板	Installation of top sliding cover plate in mold clamping area	●	●	●	●	●	○	○	○
加装一组6管冷却流量计	Installation of a set of 6-tube cooling flow meters	○	○	○	○	○	○	○	○
运水架 (进出) 配D10快插接头	Water carrier (in and out) with D10 quick connector	○	○	○	○	○	○	○	○
六进六出运水架 (进出) 配D12快插接头	6 in 6 out Water carrier (in and out) with D12 quick connector	●	●	●	●	●	●	●	●

液压部分 Hydraulic Part		TM90	TM130	TM170	TM220	TM260	TM330	TM400	TM470
标配一组液压抽芯	Standard 1 set hydraulic core pulling	●	●	●	●	●	●	○	○
标配二组液压抽芯	Standard 2 sets hydraulic core pulling	○	○	○	○	○	○	●	●
加装一组液压抽芯	Add a set of hydraulic core pulling system	○	○	○	○	○	○	○	○
加装二组液压抽芯	Add two sets of hydraulic core pulling system	○	○	○	○	○	○	○	○
加装三组液压抽芯	Add three sets of hydraulic core pulling system	○	○	○	○	○	○	○	○
一组液压抽芯配快速接头	One set of hydraulic core pulling system with quick coupling	○	○	○	○	○	○	○	○
二组液压抽芯配快速接头	Two sets of hydraulic core pulling system with quick coupling	○	○	○	○	○	○	○	○
三组液压抽芯配快速接头	Three sets of hydraulic core pulling system with quick coupling	○	○	○	○	○	○	○	○
一组气动抽芯	One set of pneumatic core pulling system	○	○	○	○	○	○	○	○
一组吹风	One set of aeration system	○	○	○	○	○	○	○	○
二组吹风	Two sets of aeration system	○	○	○	○	○	○	○	○
三组吹风	Three sets of aeration system	○	○	○	○	○	○	○	○
液压旋转脱模 (不带液压马达)	Hydraulic rotary demoulding (without hydraulic motor)	○	○	○	○	○	○	○	○
液压旋转脱模 (带液压马达)	Hydraulic rotary demoulding (with hydraulic motor)	○	○	○	○	○	○	○	○
抽芯增加叠加单向阀	Core pulling system with stacked check valve	○	○	○	○	○	○	○	○
顶针增加叠加单向阀	Thimble with stacked check valve	○	○	○	○	○	○	○	○
调模刹车液压马达	Hydraulic motor for mold adjustment brake	○	○	○	○	○	○	○	○
开模同步顶针	Synchronous thimble for mould opening	○	○	○	○	○	○	○	○
液压同步熔胶回路	Hydraulic synchronous glue melting circuit	○	○	○	○	○	○	○	○
液压同步抽芯回路	Hydraulic synchronous core pulling circuit	○	○	○	○	○	○	○	○
加装射移单向阀	With Carriage movement check valve	●	●	●	●	●	●	●	●
数控背压	CNC back pressure	●	●	●	●	●	●	●	●
液压安全锁	Hydraulic safety lock	●	●	●	●	●	●	●	●
加大一级油泵电机	Upgrade the oil pump motor by a grade	○	○	○	○	○	○	○	○
加大两级油泵电机	Upgrade the oil pump motor by two grades	○	○	○	○	○	○	○	○
伺服注射系统	Servo injection system	○	○	○	○	○	○	○	○
油温预热功能	Oil temperature preheating function	○	○	○	○	○	○	○	○
加大油冷却器	Upgrade oil cooler	○	○	○	○	○	○	○	○
加装冷却水控制阀	Installation of cooling water control valve	○	○	○	○	○	○	○	○
配力士乐电磁阀	Equip Rexroth solenoid valve	○	○	○	○	○	○	○	○
高速伺服开合模阀	High speed servo opening and closing valve	○	○	○	○	○	○	○	○
加装射移单向阀	Installation of shooting and movement check valve	●	●	●	●	●	●	●	●
加装高压软管防爆链	Installation of high pressure hose explosion-proof chain	●	●	●	●	●	●	●	●

电气部分 Electrical Part		TM90	TM130	TM170	TM220	TM260	TM330	TM400	TM470
电动旋转脱模 (不含马达)	Electric rotary demoulding (excluding motor)	○	○	○	○	○	○	○	○
电压改为220V/3PH/60HZ	Voltage changed to 220V/3PH/60HZ	○	○	○	○	○	○	○	○
电压改为440V/3PH/50HZ	Voltage changed to 440V/3PH/50HZ	○	○	○	○	○	○	○	○
加装三色报警灯	Installation of three-color alarm light	●	●	●	●	●	●	●	●
一组2+3 220V/10A插座	One set 2+3 220V/10A power socket	●	●	●	●	●	●	●	●
二组三相32A插座	2 sets 2P 32A power socket	●	●	●	●	●	●	●	●
加装一组三相32A插座	Installation of a set of three-phase 32A socket	○	○	○	○	○	○	○	○
加装二组三相32A插座	Installation of two sets of three-phase 32A socket	○	○	○	○	○	○	○	○
加装三组三相32A插座	Installation of three sets of three-phase 32A socket	○	○	○	○	○	○	○	○
加装四组三相32A插座	Installation of four sets of three-phase 32A socket	○	○	○	○	○	○	○	○
配陶瓷发热圈	Equip ceramic heating ring	○	○	○	○	○	○	○	○
加装模具返回确认	Add mould for return confirmation	●	●	●	●	●	●	●	●
射嘴独立控制	Independent nozzle control	●	●	●	●	●	●	●	●
后门急停按钮	Emergency stop button of rear door	●	●	●	●	●	●	●	●
熔胶转速测试装置	Speed test device for glue melting	●	●	●	●	●	●	●	●
配8.4寸显示屏	Equip 8.4" display screen	●	●	●	●	●	●	●	●
配10寸显示屏	Equip 10" display screen	○	○	○	○	○	○	○	○
油位警报	Oil level alarm	○	○	○	○	○	○	○	○
油温过高报警	Super high oil temperature alarm	●	●	●	●	●	●	●	●
加装电度表	Installation of watt hour meter	○	○	○	○	○	○	○	○
加热用固态继电器	Solid state relay for heating	●	●	●	●	●	●	●	●
热流道接口 (接电脑)	Hot runner interface (connected to computer)	○	○	○	○	○	○	○	○
气辅注射装置接口	Interface of gas assisted injection device	○	○	○	○	○	○	○	○
加装两组模具温控	Add two sets of mould for temperature control	○	○	○	○	○	○	○	○
锁模力检测及显示	Clamping force detection and display	○	○	○	○	○	○	○	○
加装电脑操作面板资料锁	Data lock installation for computer operation panel	○	○	○	○	○	○	○	○
顺序射胶接口	Sequential glue injection interface	○	○	○	○	○	○	○	○
顺序射胶 (带顺序阀)	Sequential injection (with sequence valve)	○	○	○	○	○	○	○	○
欧规 67	European standard 67	○	○	○	○	○	○	○	○
欧规12	European standard 12	○	○	○	○	○	○	○	○

其他部分 Other Part		TM90	TM130	TM170	TM220	TM260	TM330	TM400	TM470
射台表面加花纹板	Pattern plate on the surface of shooting table	●	●	●	●	●	●	●	●
更改钣金颜色 (A/A2以外颜色)	Change metal plate color (color other than A/A2)	○	○	○	○	○	○	○	○
更改射台颜色 (A/A2以外颜色)	Change the color of the injection platform (color other than A/A2)	○	○	○	○	○	○	○	○
更改锁模颜色 (A/A2以外颜色)	Change mould clamping color (color other than A/A2)	○	○	○	○	○	○	○	○
更改机架颜色 (A/A2以外颜色)	Change rack color (color other than A/A2)	○	○	○	○	○	○	○	○

备注: 标准配置 "●" 和备选配置 "○"
Remark: Standard "●" Optional "○"

03

Chapter of Service
客户服务

售后服务、全球服务网点
After-Sale Service、Global Service Net

After-Sale Service

售后服务



快速响应

快速响应客户的需求，收集客户的现场信息并记录故障，给出保养合理化建议；

Fast Response

Quickly respond to customer needs, collect customer site information and record the failure, give reasonable maintenance suggestions;



快速到达

快速到达客户现场，进行设备维修；

Fast Arrival

Quickly arrive at customer site for equipment maintenance;



快速处理

快速处理，帮助客户第一时间将设备调整到最佳状态；

Fast Processing

Quickly processing to help customers adjust the equipment to the best state in the first time;



快速验收

快速完成服务项目验收。

Fast Acceptance

Quickly complete the service project acceptance.

Global Service Net

全球服务网点

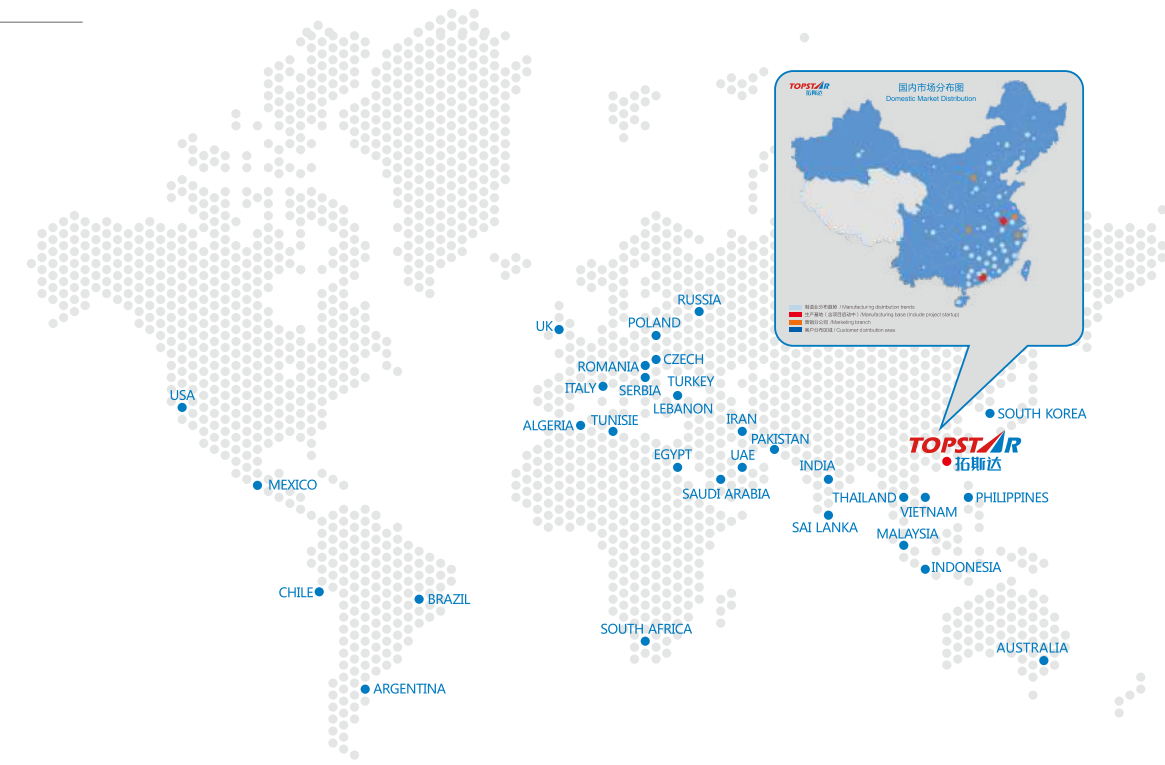

sincerely appreciate

衷心感谢

超过15000家客户见证并长期支持

Over 15000 customer have witnessed TOPSTAR growth and long supports

